



STARR
POWER TONGS

9-7/8" 60 SPECIFICATIONS

9-7/8" 60-BR



TORQUE - Rineer 21IN ³ 60K Tong					RPM - Rineer 21IN ³ 60K Tong				
Press.	Speed 1	Speed 2	Speed 3	Speed 4	GPM	Speed 1	Speed 2	Speed 3	Speed 4
PSI	ft-lb.	ft-lb.	ft-lb.	ft-lb.					
1000	23,208	4,093	11,604	2,047	10	0.9	5	1.8	10.1
2000	46,415	8,186	23,208	4,093	20	1.8	10.1	3.6	20.2
2250	52,217	9,210	26,109	4,605	40	3.6	20.2	7.1	40.4
2500	58,019	10,233	29,009	5,117	60	5.3	30.3	10.7	60.6
2750	63,821	11,256	31,910	5,628					
3000	69,623	12,280	34,811	6,140					

NOTE – 2 Options Available
9-7/8" 60 – (1 Handle – 2 Capped Valves)
9-7/8" 60-BR (Ready to Receive 10-3/4 Backup)

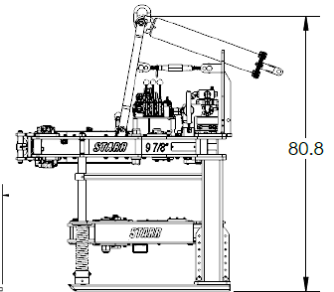
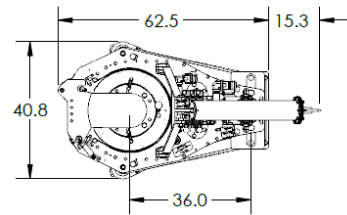

	Motor Shift	Tong Transmission Shift
Speed 1	Low Gear	Low Gear
Speed 2	Low Gear	High Gear
Speed 3	High Gear	Low Gear
Speed 4	High Gear	High Gear

	9 7/8" Tong	9 7/8" Tong w/ Backup
Width	37" (94 cm)	40.8" (103.6 cm)
Length	61.3" (155.7 cm)	62.5" (158.8 cm)
Height	47.5" (120.6 cm)	78.9" (200.4 cm)
Weight	2,150lb. (977kg)	3,300lb. (1'500kg)
Rated Pressure	2500 psi	
Rated Torque	60,000 ft-lbs.	
Handle Length	36" (91.4 cm)	

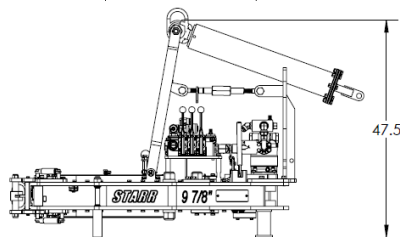

TONG JAWS AVAILABLE: 4 1/2" – 9 7/8"
BACKUP JAWS AVAILABLE: 3 1/2" – 10 3/4"

(Other sizes available upon request)
 Disclaimer: Technical Values are +/- 5% of Listed Values